



November 2, 2015

## Midtown's Post Office-Topping Condos Debut From \$895,000



**Name/Address:** The Sorting House, 318 West 52nd Street

**Developer:** Cadence Property Group

**Architect:** Architecture Outfit

**Size:** 30 "loft residences"

**Prices:** From \$895,000

**Sales and Marketing:** Halstead Property Development Marketing

In New York City, pretty much anything can be **converted** into a luxury condo: [parking garages](#), [gas stations](#), empty lots, even [churches](#) have all found **second lives** as pricey

homes. Add post offices to that list: The **Radio City Station Post Office** on West 52nd Street will get a new addition with **The Sorting House**, a **three-story** topper (the developer, Cadence Property Group, will add two floors and renovate a third pre-existing one) with 30 "loft residences." (Translation: big, open apartments.)

Despite **opposition** from Midtown West residences, who worried that the addition will **compromise** the **Special District Clinton zoning laws**, a number of units are now on the market (which should provide the USPS with some **much-needed funds**).

Apartments come in a few configurations—"open lofts" (re: studios); one-, two-, and three bedrooms; duplexes; and penthouses—and have all the de rigueur luxury condo offerings (oak floors, marble kitchens, **high ceilings**), along with building amenities like a common **roof space** and a gym. The smallest unit available, a 600-square-foot studio, is **\$895,000**; the largest is a three-bedroom asking **\$2.625 million**.







# THE SORTING HOUSE

## LOFT 4H

Interior: 1,400 sq ft / 13090 sq m  
 Exterior: 272 sq ft / 25462 sq m

3 Bedrooms  
 2 Bathrooms  
 1 Powder room  
 Roof Deck

### Builder's Features

- Master suite with walk-in closet and his-and-hers bathroom
- Private and secure with outdoor exposure
- Walk-in pantry

### Finishes and Design

- Colorful light up to 40' ceiling space
- 2" White Oak flooring
- Overhead recessed lighting with high performance, energy efficient low E glass
- SmartHome control
- Stainless steel kitchen counter top and backsplash
- High-end appliance package including state-of-the-art refrigerator
- Custom White Oak master bath suite with finished brass towel bar/linen closet and tiled walls
- 3.0 washer and dryer

© 2024 The Home Depot. All rights reserved. The information provided herein is for informational purposes only and does not constitute an offer. The actual features, finishes and design of the property may vary from those shown in this rendering. The information is subject to change without notice. The information is provided as a guide only and does not constitute an offer. The actual features, finishes and design of the property may vary from those shown in this rendering. The information is subject to change without notice. The information is provided as a guide only and does not constitute an offer. The actual features, finishes and design of the property may vary from those shown in this rendering. The information is subject to change without notice.

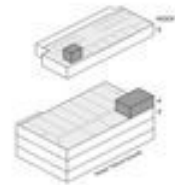
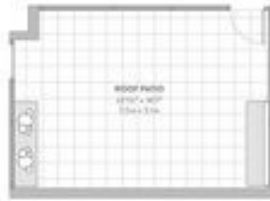

# THE SORTING HOUSE

## DUPLEX 4F

Interior: 1,294 sq ft / 11929 sq m  
 Exterior: 292 sq ft / 27099 sq m

2 Bedrooms  
 2 Bathrooms  
 1 Powder room  
 1 Terrace

### Builder's Features

- Master suite with walk-in closet and his-and-hers bathroom
- Second bathroom with master bathroom
- Expansive private terrace adjacent to guest suite
- Walk-in pantry with custom storage shelving system
- Under-stair storage and his-and-hers closet with integrated smartHome device

### Finishes and Design

- Colorful light up to 40' ceiling space
- 2" White Oak flooring
- Overhead recessed lighting with high performance, energy efficient low E glass
- SmartHome control
- Stainless steel kitchen counter top and backsplash
- High-end appliance package including state-of-the-art refrigerator
- Custom White Oak master bath suite with finished brass towel bar/linen closet and tiled walls
- 3.0 washer and dryer

© 2024 The Home Depot. All rights reserved. The information provided herein is for informational purposes only and does not constitute an offer. The actual features, finishes and design of the property may vary from those shown in this rendering. The information is subject to change without notice. The information is provided as a guide only and does not constitute an offer. The actual features, finishes and design of the property may vary from those shown in this rendering. The information is subject to change without notice.

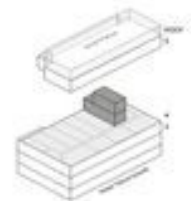

# THE SORTING HOUSE

## LOFT 3D

Interior: 496 sq ft / 46,24 sq m  
 Exterior: 226 sq ft / 21,09 sq m

1 Bedroom  
 1 Bathroom  
 Dog/Patio

### Residence Features

- Flexible master suite with walk-in closet and two-drawer dresser
- Private roof patio with excellent exposure
- Sliding wall doors along ceiling track into parklet or out to deck, living space, with storage and passage door

### Finishes and Design

- Ceiling heights up to 10' in living space
- 3" White Oak flooring
- Overhead recessed lighting with high performance, energy efficient LED glass
- Balcony made of white brick, concrete steps and deck boards
- Major appliance package including state-of-the-art induction cooking
- Custom White Oak master bath vanity with finished concrete island, freestanding vanity and tiled walls
- 32 windows and doors

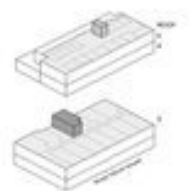

# THE SORTING HOUSE

## OPEN LOFT 3C

Interior: 603 sq ft / 56,29 sq m

Open Loft  
 1 Bathroom

### Finishes and Design

- Ceiling heights up to 10' in living space
- 3" White Oak flooring
- Overhead recessed lighting with high performance, energy efficient LED glass
- Balcony made of white brick, concrete steps and deck boards
- Major appliance package including state-of-the-art induction cooking
- Custom White Oak master bath vanity with finished concrete island, freestanding vanity and tiled walls
- 32 windows and doors

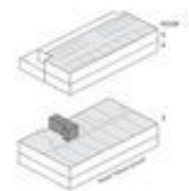

[http://ny.curbed.com/archives/2015/11/02/midtowns\\_post\\_officetopping\\_condos\\_debut\\_from\\_895000.php](http://ny.curbed.com/archives/2015/11/02/midtowns_post_officetopping_condos_debut_from_895000.php)